

## ClickitBase Cellular Signal Amplifier with Connector



**Step 1 - Plug in the unit**

**Step 2 - Connect the external antenna to the side marked "ANT"**

**Step 3 - Attach the direct connect cable to the side marked "PHONE"**

**Step 4 - Attach the smaller end of the direct connect cable to your phone**

You will likely need to remove a plug on the back of your phone to expose the antenna connection port

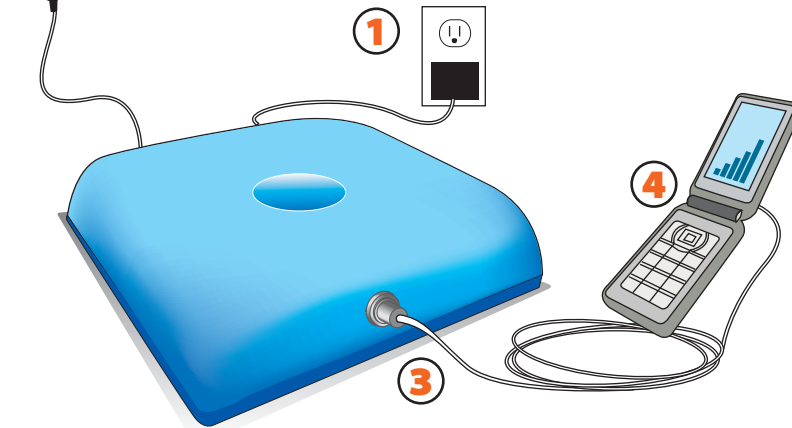

### PACKAGE INCLUDES

- SignalWide cell phone signal amplifier
- 78" DC Power Cable
- Additional Power Cable (for hardwire installation)
- AC/DC Adapter
- External Antenna
- Direct Connect Cable
- Carrying Case

### Connecting to your phone

Remove the plug to expose the external antenna port.

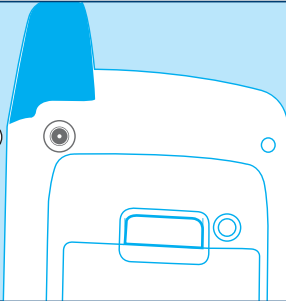

Place the connector into the port and press firmly.

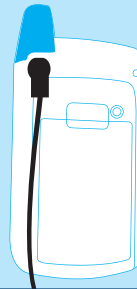

You should see a change in reception within twenty seconds.



**WARRANTY** SignalWide™ warrants that this product is free from any defects in material or workmanship for a period of one year. If a defect in material or workmanship is found, SignalWide™ agrees to repair or replace the product at its own discretion, free of charge to the original purchaser. Please return the product along with proof of purchase to the original authorized dealer. This warranty is null and void if the product has been modified, abused, tampered with, subjected to abnormal conditions, or transferred to someone other than the original purchaser.

**PRE-CAUTIONS** Directly wired vehicle antennas, mounted a minimum distance of 20 cm (7.87 inches) away from the body of any user or nearby persons is recommended. Mounting an amplifier in the engine cavity or on the underside of the vehicle will void the manufacturer's warranty. Subjecting the amplifier to voltages greater than 30 Volts DC will damage the amplifier and void the manufacturer's warranty. Any vehicle with an electrical system of greater than 30 Volts DC should use a step-down voltage regulator to bring the voltage within the DC operating power range of the amplifier (10 to 30V dc). Under no circumstances should the amplifier be powered up without a properly connected 50 ohm 800/1900 MHz dual band cellular/PCS antenna or the amplifier may be damaged, resulting in the manufacturer's warranty being void. For optimum performance and compatibility with cellular service provider requirements, it is recommended that an external antenna with a maximum gain of 3dB be installed. Use of cellular amplifiers with antennas of higher gains than 7 dBi gain is in violation of FCC regulations for which the offender will be fully liable, and warranty claims will be void.

**Question? 818.292.8960 or [question@signalwide.com](mailto:question@signalwide.com)**

[www.SignalWide.com](http://www.SignalWide.com)

Made in the USA

SignalWide, Inc.  
169 Padua Circle  
Newbury Park, CA 91320

